

# CEILINGS

## A. Installation

1. Fasten ConcritBoard to ceiling joists or other framing members with a fastener every 150mm.
2. A gap should be left between abutting panels 3 to 5mm-wide and filled solid with mortar and covered with fibreglass tape embedded in a very thin skim coat of mortar.
3. Bond ceramic tile to ConcritBoard panel as described in "Bonding Ceramic Tile".

## B. Requirements

- Completed ceiling assembly deflection due to dead load, including insulation, ConcritBoard, mortar and facing, shall not exceed 1/360 of span.
- Dead load applied to any ceiling frame member, including ConcritBoard, mortar and facing material shall not exceed 0.65kg/m<sup>2</sup>.
- Ceiling joist or cross bracings shall not be spaced more than 457mm. Steel cross bracings must be 1mm or thicker.



# COUNTERTOPS

## COUNTERTOPS

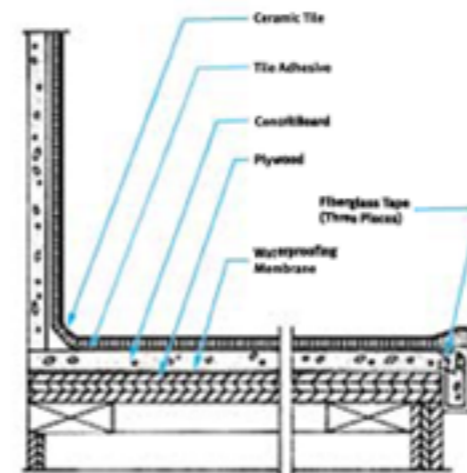

## A. Installation

1. Install 18mm exterior grade plywood across unit supports spaced a maximum of 457mm.
2. Fasten ConcritBoard to plywood with 30mm screws or 38mm galvanized roofing nails (preferably ring-shanked) spaced 200mm in field of and around edges. (See "Fastening".)
3. Prefill joints with latex-portland cement mortar and embed a 50mm-wide coated fibreglass mesh tape in a thin coat of mortar, forcing it through the tape to fill and level the joints.

## B. Requirements

- Plywood base must be installed flat and level.
- Bottom edge of countertop trim must be set proper distance above the finish floor material to allow clearance for dishwashers and compactors.
- Use extra-duty glazed tile or unglazed tile.
- Use a liquid trowel-applied waterproof membrane to seal edge and bottom of plywood overhang at face of counter and all other plywood surfaces and edges that will be exposed to water or moisture.

For detailed information, please contact:

**CONCRITBOARD**  
Builders' Solution

**SLIDE & HIDE System (S) Pte Ltd**  
ConcritBoard Division

32 Ang Mo Kio Industrial Park 2 #02-04, Sing Industrial Complex, Singapore 569510  
Tel: +65-6484 0166 / Fax: +65-6484 0136  
E-mail: sales@concritboard.com / Website: www.concritboard.com

- "ConcritBoard" is a registered trademark of SLIDE & HIDE System (S) Pte Ltd.
- The reproduction of this catalogue or parts of it or copying of the layout is prohibited.
- The technical presentation and data including illustrations and drawings are not binding. We reserve the right to make improvements when necessary.